

Appendix 1

**Application for a premises licence to be granted
under the Licensing Act 2003**

PLEASE READ THE FOLLOWING INSTRUCTIONS FIRST

Before completing this form please read the guidance notes at the end of the form.
If you are completing this form by hand please write legibly in block capitals. In all cases ensure that your answers are inside the boxes and written in black ink. Use additional sheets if necessary.

You may wish to keep a copy of the completed form for your records.

I/We Mr Suat Asan

(Insert name(s) of applicant)

apply for a premises licence under section 17 of the Licensing Act 2003 for the premises described in Part 1 below (the premises) and I/we are making this application to you as the relevant licensing authority in accordance with section 12 of the Licensing Act 2003

Part 1 – Premises Details

| | | | | | |
|---|--------|-------|-----------|---|--|
| Postal address of premises or, if none, ordnance survey map reference or description Meze Bar Restaurant 150 Roman Road | | | | <div style="border: 1px solid black; padding: 5px; text-align: center;"> LBTH TRADING STANDARDS 08 OCT 2013 </div> | |
| Post town | London | | Post code | | |
| Telephone number at premises (if any) | | | | LICENSING | |
| Non-domestic rateable value of premises | | £9200 | | | |

Part 2 - Applicant Details

Please state whether you are applying for a premises licence as
Please tick yes

- a) an individual or individuals * please complete section (A)
- b) a person other than an individual *
 - i. as a limited company please complete section (B)
 - ii. as a partnership please complete section (B)
 - iii. as an unincorporated association or please complete section (B)
 - iv. other (for example a statutory corporation) please complete section (B)
- c) a recognised club please complete section (B)
- d) a charity please complete section (B)

- e) the proprietor of an educational establishment please complete section (B)
- f) a health service body please complete section (B)
- g) a person who is registered under Part 2 of the Care Standards Act 2000 (c14) in respect of an independent hospital please complete section (B)
- h) the chief officer of police of a police force in England and Wales please complete section (B)

* If you are applying as a person described in (a) or (b) please confirm:

Please tick yes

- I am carrying on or proposing to carry on a business which involves the use of the premises for licensable activities; or
- I am making the application pursuant to a
 - statutory function or
 - a function discharged by virtue of Her Majesty's prerogative

(A) INDIVIDUAL APPLICANTS (fill in as applicable)

| | | | | | |
|--|------------------------------|-------------------------------|-----------------------------|---|------------|
| Mr <input checked="" type="checkbox"/> | Mrs <input type="checkbox"/> | Miss <input type="checkbox"/> | Ms <input type="checkbox"/> | Other Title (for example, Rev) | |
| Surname Asan | | | First names Suat | | |
| I am 18 years old or over | | | | <input checked="" type="checkbox"/> Please tick yes | |
| Current postal address if different from premises address | | [REDACTED] | | | |
| Post Town | London | | | Postcode | [REDACTED] |
| Daytime contact telephone number | | | | | |
| E-mail address (optional) | | | | | |

SECOND INDIVIDUAL APPLICANT (if applicable)

| | | | | | |
|-----------------------------|------------------------------|-------------------------------|-----------------------------|--|--|
| Mr <input type="checkbox"/> | Mrs <input type="checkbox"/> | Miss <input type="checkbox"/> | Ms <input type="checkbox"/> | Other Title (for example, Rev) | |
| Surname | | | First names | | |
| I am 18 years old or over | | | | <input type="checkbox"/> Please tick yes | |

| | | | |
|--|--|-----------------|--|
| Current postal address if different from premises address | | | |
| Post Town | | Postcode | |
| Daytime contact telephone number | | | |
| E-mail address (optional) | | | |

(B) OTHER APPLICANTS

Please provide name and registered address of applicant in full. Where appropriate please give any registered number. In the case of a partnership or other joint venture (other than a body corporate), please give the name and address of each party concerned.

| |
|--|
| Name |
| Address |
| Registered number (where applicable) |
| Description of applicant (for example, partnership, company, unincorporated association etc.) |
| Telephone number (if any) |
| E-mail address (optional) |

Part 3 Operating Schedule

When do you want the premises licence to start?

| | | | | | | |
|-----|---|-------|---|------|---|---|
| Day | | Month | | Year | | |
| 0 | 5 | 1 | 1 | 2 | 0 | 1 |
| | | | | | | |

If you wish the licence to be valid only for a limited period, when do you want it to end?

| | | | | | | |
|-----|--|-------|--|------|--|--|
| Day | | Month | | Year | | |
| | | | | | | |
| | | | | | | |

Please give a general description of the premises (please read guidance note 1)

Please refer to the enclosed plan.

If 5,000 or more people are expected to attend the premises at any one time, please state the number expected to attend.

What licensable activities do you intend to carry on from the premises?

(Please see sections 1 and 14 of the Licensing Act 2003 and Schedules 1 and 2 to the Licensing Act 2003)

Provision of regulated entertainment

Please tick yes

- a) plays (if ticking yes, fill in box A)
- b) films (if ticking yes, fill in box B)
- c) indoor sporting events (if ticking yes, fill in box C)
- d) boxing or wrestling entertainment (if ticking yes, fill in box D)
- e) live music (if ticking yes, fill in box E)
- f) recorded music (if ticking yes, fill in box F)
- g) performances of dance (if ticking yes, fill in box G)
- h) anything of a similar description to that falling within (e), (f) or (g) (if ticking yes, fill in box H)

Provision of entertainment facilities:

- i) making music (if ticking yes, fill in box I)
- j) dancing (if ticking yes, fill in box J)
- k) entertainment of a similar description to that falling within (i) or (j) (if ticking yes, fill in box K)

Provision of late night refreshment (if ticking yes, fill in box L)

Supply of alcohol (if ticking yes, fill in box M)

In all cases complete boxes N, O and P

A

| Plays Standard days and timings (please read guidance note 6) | | | Will the performance of a play take place indoors or outdoors or both – please tick (please read guidance note 2) | Indoors | <input type="checkbox"/> |
|--|-------|--------|--|----------|--------------------------|
| Day | Start | Finish | | Outdoors | <input type="checkbox"/> |
| Mon | | | Please give further details here (please read guidance note 3) | Both | <input type="checkbox"/> |
| | | | | | |
| Tue | | | State any seasonal variations for performing plays (please read guidance note 4) | | |
| | | | | | |
| Wed | | | Non standard timings. Where you intend to use the premises for the performance of plays at different times to those listed in the column on the left, please list (please read guidance note 5) | | |
| Thur | | | | | |
| Fri | | | | | |
| Sat | | | | | |
| Sun | | | | | |

B

| | | | | | |
|---|--------------|---------------|--|----------|--------------------------|
| Films Standard days and timings (please read guidance note 6) | | | <u>Will the exhibition of films take place indoors or outdoors or both – please tick</u> (please read guidance note 2) | Indoors | <input type="checkbox"/> |
| | | | | Outdoors | <input type="checkbox"/> |
| | | | | Both | <input type="checkbox"/> |
| Day | Start | Finish | <u>Please give further details here</u> (please read guidance note 3) | | |
| Mon | | | | | |
| Tue | | | <u>State any seasonal variations for the exhibition of films</u> (please read guidance note 4) | | |
| Wed | | | | | |
| Thur | | | <u>Non standard timings. Where you intend to use the premises for the exhibition of films at different times to those listed in the column on the left, please list</u> (please read guidance note 5) | | |
| Fri | | | | | |
| Sat | | | | | |
| Sun | | | | | |

C

| | | | |
|--|-------|--------|---|
| Indoor sporting events Standard days and timings (please read guidance note 6) | | | <u>Please give further details</u> (please read guidance note 3) |
| Day | Start | Finish | |
| Mon | | | <u>State any seasonal variations for indoor sporting events</u> (please read guidance note 4) |
| Tue | | | |
| Wed | | | |
| Thur | | | <u>Non standard timings. Where you intend to use the premises for indoor sporting events at different times to those listed in the column on the left, please list</u> (please read guidance note 5) |
| Fri | | | |
| Sat | | | |
| Sun | | | |
| | | | |

D

| Boxing or wrestling entertainments Standard days and timings (please read guidance note 6) | | | <u>Will the boxing or wrestling entertainment take place indoors or outdoors or both – please tick</u> (please read guidance note 2) | Indoors | <input type="checkbox"/> |
|--|-------|--------|--|----------|--------------------------|
| Day | Start | Finish | | Outdoors | <input type="checkbox"/> |
| Mon | | | <u>Please give further details here</u> (please read guidance note 3) | Both | <input type="checkbox"/> |
| Tue | | | | | |
| Wed | | | <u>State any seasonal variations for boxing or wrestling entertainment</u> (please read guidance note 4) | | |
| Thur | | | | | |
| Fri | | | <u>Non standard timings. Where you intend to use the premises for boxing or wrestling entertainment at different times to those listed in the column on the left, please list</u> (please read guidance note 5) | | |
| Sat | | | | | |
| Sun | | | | | |

E

| | | | | | |
|--|--------------|---------------|--|----------|--------------------------|
| Live music Standard days and timings (please read guidance note 6) | | | <u>Will the performance of live music take place indoors or outdoors or both – please tick</u> (please read guidance note 2) | Indoors | <input type="checkbox"/> |
| | | | | Outdoors | <input type="checkbox"/> |
| | | | | Both | <input type="checkbox"/> |
| Day | Start | Finish | <u>Please give further details here</u> (please read guidance note 3) | | |
| Mon | | | | | |
| | | | <u>State any seasonal variations for the performance of live music</u> (please read guidance note 4) | | |
| Tue | | | | | |
| | | | <u>Non standard timings. Where you intend to use the premises for the performance of live music at different times to those listed in the column on the left, please list</u> (please read guidance note 5) | | |
| Wed | | | | | |
| | | | | | |
| Thur | | | | | |
| | | | | | |
| Fri | | | | | |
| | | | | | |
| Sat | | | | | |
| | | | | | |
| Sun | | | | | |

F

| | | | | | |
|--|--------------|---------------|--|----------|--------------------------|
| Recorded music Standard days and timings (please read guidance note 6) | | | <u>Will the playing of recorded music take place indoors or outdoors or both – please tick</u> (please read guidance note 2) | Indoors | <input type="checkbox"/> |
| | | | | Outdoors | <input type="checkbox"/> |
| | | | | Both | <input type="checkbox"/> |
| Day | Start | Finish | <u>Please give further details here</u> (please read guidance note 3) | | |
| Mon | | | | | |
| Tue | | | <u>State any seasonal variations for the playing of recorded music</u> (please read guidance note 4) | | |
| Wed | | | | | |
| Thur | | | <u>Non standard timings. Where you intend to use the premises for the playing of recorded music at different times to those listed in the column on the left, please list</u> (please read guidance note 5) | | |
| Fri | | | | | |
| Sat | | | | | |
| Sun | | | | | |

G

| | | | | | |
|---|--------------|---------------|---|----------|--------------------------|
| Performances of dance Standard days and timings (please read guidance note 6) | | | <u>Will the performance of dance take place indoors or outdoors or both – please tick</u> (please read guidance note 2) | Indoors | <input type="checkbox"/> |
| | | | | Outdoors | <input type="checkbox"/> |
| | | | | Both | <input type="checkbox"/> |
| Day | Start | Finish | <u>Please give further details here</u> (please read guidance note 3) | | |
| Mon | | | | | |
| | | | | | |
| Tue | | | | | |
| | | | <u>State any seasonal variations for the performance of dance</u> (please read guidance note 4) | | |
| Wed | | | | | |
| | | | | | |
| Thur | | | | | |
| | | | <u>Non standard timings. Where you intend to use the premises for the performance of dance at different times to those listed in the column on the left, please list</u> (please read guidance note 5) | | |
| Fri | | | | | |
| | | | | | |
| Sat | | | | | |
| | | | | | |
| Sun | | | | | |

H

| | | | | | |
|--|--------------|---------------|--|----------|--------------------------|
| Anything of a similar description to that falling within (e), (f) or (g) Standard days and timings (please read guidance note 6) | | | <u>Please give a description of the type of entertainment you will be providing</u> | | |
| Day | Start | Finish | <u>Will this entertainment take place indoors or outdoors or both – please tick</u> (please read guidance note 2) | Indoors | <input type="checkbox"/> |
| Mon | | | | Outdoors | <input type="checkbox"/> |
| | | | | Both | <input type="checkbox"/> |
| Tue | | | <u>Please give further details here</u> (please read guidance note 3) | | |
| | | | | | |
| Wed | | | | | |
| Thur | | | <u>State any seasonal variations for entertainment of a similar description to that falling within (e), (f) or (g)</u> (please read guidance note 4) | | |
| Fri | | | | | |
| Sat | | | <u>Non standard timings. Where you intend to use the premises for the entertainment of a similar description to that falling within (e), (f) or (g) at different times to those listed in the column on the left, please list</u> (please read guidance note 5) | | |
| Sun | | | | | |

| | | | | |
|--|-------|--------|---|--|
| Provision of facilities for making music Standard days and timings (please read guidance note 6) | | | <u>Please give a description of the facilities for making music you will be providing</u> | |
| | | | <u>Will the facilities for making music be indoors or outdoors or both – please tick</u> (please read guidance note 2) | |
| | | | Outdoors <input type="checkbox"/> | |
| Day | Start | Finish | Both <input type="checkbox"/> | |
| Mon | | | <u>Please give further details here</u> (please read guidance note 3) | |
| | | | | |
| Tue | | | <u>State any seasonal variations for the provision of facilities for making music</u> (please read guidance note 4) | |
| | | | | |
| Wed | | | <u>Non standard timings. Where you intend to use the premises for provision of facilities for making music at different times to those listed in the column on the left, please list</u> (please read guidance note 5) | |
| | | | | |
| Thur | | | | |
| | | | | |
| Fri | | | | |
| | | | | |
| Sat | | | | |
| | | | | |
| Sun | | | | |
| | | | | |

J

| | | | | | |
|---|--------------|---------------|--|----------|--------------------------|
| Provision of facilities for dancing Standard days and timings (please read guidance note 6) | | | <u>Will the facilities for dancing be indoors or outdoors or both – please tick</u> (see guidance note 2) | Indoors | <input type="checkbox"/> |
| | | | | Outdoors | <input type="checkbox"/> |
| | | | | Both | <input type="checkbox"/> |
| | | | <u>Please give a description of the facilities for dancing you will be providing</u> | | |
| Day | Start | Finish | <u>Please give further details here</u> (please read guidance note 3) | | |
| Mon | | | | | |
| Tue | | | | | |
| Wed | | | | | |
| Thur | | | | | |
| Fri | | | | | |
| Sat | | | | | |
| Sun | | | <u>State any seasonal variations for providing dancing facilities</u> (please read guidance note 4) | | |
| | | | <u>Non standard timings. Where you intend to use the premises for the provision of facilities for dancing entertainment at different times to those listed in the column on the left, please list</u> (please read guidance note 5) | | |

K

| | | | | |
|--|-------|--------|---|-----------------------------------|
| Provision of facilities for entertainment of a similar description to that falling within i or j Standard days and timings (please read guidance note 6) | | | <u>Please give a description of the type of entertainment facility you will be providing</u> | |
| Day | Start | Finish | <u>Will the entertainment facility be indoors or outdoors or both – please tick</u> (please read guidance note 2) | Indoors <input type="checkbox"/> |
| Mon | | | | Outdoors <input type="checkbox"/> |
| | | | | Both <input type="checkbox"/> |
| Tue | | | <u>Please give further details here</u> (please read guidance note 3) | |
| Wed | | | | |
| | | | | |
| Thur | | | <u>State any seasonal variations for the provision of facilities for entertainment of a similar description to that falling within i or j</u> (please read guidance note 4) | |
| Fri | | | | |
| | | | | |
| Sat | | | <u>Non standard timings. Where you intend to use the premises for the provision of facilities for entertainment of a similar description to that falling within i or j at different times to those listed in the column on the left, please list</u> (please read guidance note 5) | |
| Sun | | | | |
| | | | | |

L

| | | | | | |
|---|--------------|---------------|---|----------|-------------------------------------|
| Late night refreshment Standard days and timings (please read guidance note 6) | | | Will the provision of late night refreshment take place indoors or outdoors or both – please tick (please read guidance note 2) | Indoors | <input checked="" type="checkbox"/> |
| | | | | Outdoors | <input type="checkbox"/> |
| | | | | Both | <input type="checkbox"/> |
| | | | | | |
| Day | Start | Finish | <u>Please give further details here</u> (please read guidance note 3) | | |
| Mon | 23:00 | 01:00 | | | |
| | | | | | |
| Tue | 23:00 | 01:00 | | | |
| | | | <u>State any seasonal variations for the provision of late night refreshment</u> (please read guidance note 4) | | |
| Wed | 23:00 | 01:00 | | | |
| | | | | | |
| Thur | 23:00 | 01:00 | | | |
| | | | <u>Non standard timings. Where you intend to use the premises for the provision of late night refreshment at different times, to those listed in the column on the left, please list</u> (please read guidance note 5) | | |
| Fri | 23:00 | 01:00 | | | |
| | | | | | |
| Sat | 23:00 | 01:00 | | | |
| | | | | | |
| Sun | N/A | N/A | | | |
| | | | | | |

M

| | | | | | |
|---|--------------|---------------|--|------------------|-------------------------------------|
| Supply of alcohol Standard days and timings (please read guidance note 6) | | | Will the supply of alcohol be for consumption (Please tick box) (please read guidance note 7) | On the premises | <input checked="" type="checkbox"/> |
| | | | | Off the premises | <input type="checkbox"/> |
| | | | | Both | <input type="checkbox"/> |
| Day | Start | Finish | State any seasonal variations for the supply of alcohol (please read guidance note 4) N/A | | |
| Mon | 12:00 | 00:30 | | | |
| | | | | | |
| Tue | 12:00 | 00:30 | | | |
| | | | | | |
| Wed | 12:00 | 00:30 | | | |
| | | | | | |
| Thur | 12:00 | 00:30 | | | |
| | | | | | |
| Fri | 12:00 | 00:30 | | | |
| | | | | | |
| Sat | 12:00 | 00:30 | | | |
| | | | | | |
| Sun | 13:00 | 22:30 | | | |
| | | | | | |

State the name and details of the individual whom you wish to specify on the licence as premises supervisor

| | |
|----|--|
| .. | |
| | |
| | |
| | |
| | |
| | |
| | |

N

Please highlight any adult entertainment or services, activities, other entertainment or matters ancillary to the use of the premises that may give rise to concern in respect of children (please read guidance note 8)
 N/A

O

| | | | |
|---|--------------|---------------|--|
| Hours premises are open to the public Standard days and timings (please read guidance note 6) | | | State any seasonal variations (please read guidance note 4) N/A |
| Day | Start | Finish | Non standard timings. Where you intend the premises to be open to the public at different times from those listed in the column on the left, please list (please read guidance note 5) N/A |
| Mon | 12:00 | 01:00 | |
| | | | |
| Tue | 12:00 | 01:00 | |
| | | | |
| Wed | 12:00 | 01:00 | |
| | | | |
| Thur | 12:00 | 01:00 | |
| | | | |
| Fri | 12:00 | 01:00 | |
| | | | |
| Sat | 12:00 | 01:00 | |
| | | | |
| Sun | 12:00 | 23:00 | |
| | | | |

P Describe the steps you intend to take to promote the four licensing objectives:

a) General – all four licensing objectives (b,c,d,e) (please read guidance note 9)

We are proposing following conditions to promote 4 licensing objectives. We would be very happy to discuss any additional conditions if necessary with responsible authorities.

b) The prevention of crime and disorder

CCTV shall be installed, operated and maintained in agreement with the Police. The system will enable frontal identification of every person entering the premises. The system shall record in real time and operate whilst the premises are open for licensable activities. The recordings shall be kept available for a minimum of 31 days. Recordings shall be made available to an Authorised Officer or a Police Officer (subject to the Data Protection Act 1998) within 24 hours of any request.

All instances of crime and disorder shall be reported to the police.

An incident book shall be used to record all instances of public disorder.

c) Public safety

All exit routes shall be kept unobstructed, with non-slippery and even surfaces, free of trip hazards and clearly identified.

d) The prevention of public nuisance

Prominent, clear and legible notices must be displayed at all exits requesting the public to respect the needs of local residents and to leave the premises and the area quietly.

e) The protection of children from harm

To protect the children from harm we have following steps taken

- 1- the premises are effectively and responsibly managed;
- 2- provision of a sufficient number of people employed or engaged
- 3- appropriate instruction, training and supervision of those employed or engaged
- 4- The licensee and staff will ask persons who appear to be under the age of 25 for photographic ID such as proof of age cards, the Connexions Card and Citizen Card, photographic driving licence or passport, an official identity card issued by HM Forces or by an EU country, bearing the photograph and date of birth of bearer.
- 5- A register of refused sales shall be kept and maintained on the premises.

Please tick yes

- I have made or enclosed payment of the fee
- I have enclosed the plan of the premises
- I have sent copies of this application and the plan to responsible authorities and others where applicable
- I have enclosed the consent form completed by the individual I wish to be premises supervisor, if applicable
- I understand that I must now advertise my application
- I understand that if I do not comply with the above requirements my application will be rejected

IT IS AN OFFENCE, LIABLE ON CONVICTION TO A FINE UP TO LEVEL 5 ON THE STANDARD SCALE, UNDER SECTION 158 OF THE LICENSING ACT 2003 TO MAKE A FALSE STATEMENT IN OR IN CONNECTION WITH THIS APPLICATION

Part 4 – Signatures (please read guidance note 10)

Signature of applicant's solicitor or other duly authorised agent (See guidance note 11) **on behalf of the applicant please state in what capacity.**

| | |
|-----------|---|
| Signature |  |
| Date | 7 th October 2013 |
| Capacity | Authorised Agent |

For joint applications signature of 2nd applicant or 2nd applicant's solicitor or other authorised agent. (please read guidance note 12). **If signing on behalf of the applicant please state in what capacity.**

| | |
|-----------|--|
| Signature | |
| Date | |
| Capacity | |

| | | | |
|---|------------|------------------|---------|
| Contact name (where not previously given) and postal address for correspondence associated with this application (please read guidance note 13) Licensing Department NARTS 53 Stoke Newington High Street | | | |
| Post town | London | Post code | N16 8EL |
| Telephone number (if any) | [REDACTED] | | |
| If you would prefer us to correspond with you by e-mail your e-mail address (optional) [REDACTED] | | | |

Notes for Guidance

1. Describe the premises. For example the type of premises, its general situation and layout and any other information which could be relevant to the licensing objectives. Where your application includes off-supplies of alcohol and you intend to provide a place for consumption of these off-supplies you must include a description of where the place will be and its proximity to the premises.
2. Where taking place in a building or other structure please tick as appropriate. Indoors may include a tent.
3. For example the type of activity to be authorised, if not already stated, and give relevant further details, for example (but not exclusively) whether or not music will be amplified or unamplified.
4. For example (but not exclusively), where the activity will occur on additional days during the summer months.
5. For example (but not exclusively), where you wish the activity to go on longer on a particular day e.g. Christmas Eve.
6. Please give timings in 24 hour clock (e.g. 16:00) and only give details for the days of the week when you intend the premises to be used for the activity.
7. If you wish people to be able to consume alcohol on the premises please tick on, if you wish people to be able to purchase alcohol to consume away from the premises please tick off. If you wish people to be able to do both please tick both.
8. Please give information about anything intended to occur at the premises or ancillary to the use of the premises which may give rise to concern in respect of children, regardless of whether you intend children to have access to the premises, for example (but not exclusively) nudity or semi-nudity, films for restricted age groups, the presence of gaming machines.
9. Please list here steps you will take to promote all four licensing objectives together.
10. The application form must be signed.
11. An applicant's agent (for example solicitor) may sign the form on their behalf provided that they have actual authority to do so.
12. Where there is more than one applicant, both applicants or their respective agents must sign the application form.
13. This is the address which we shall use to correspond with you about this application.

LBTH
 TRADING STANDARDS
 13 OCT 2013
 LICENSING

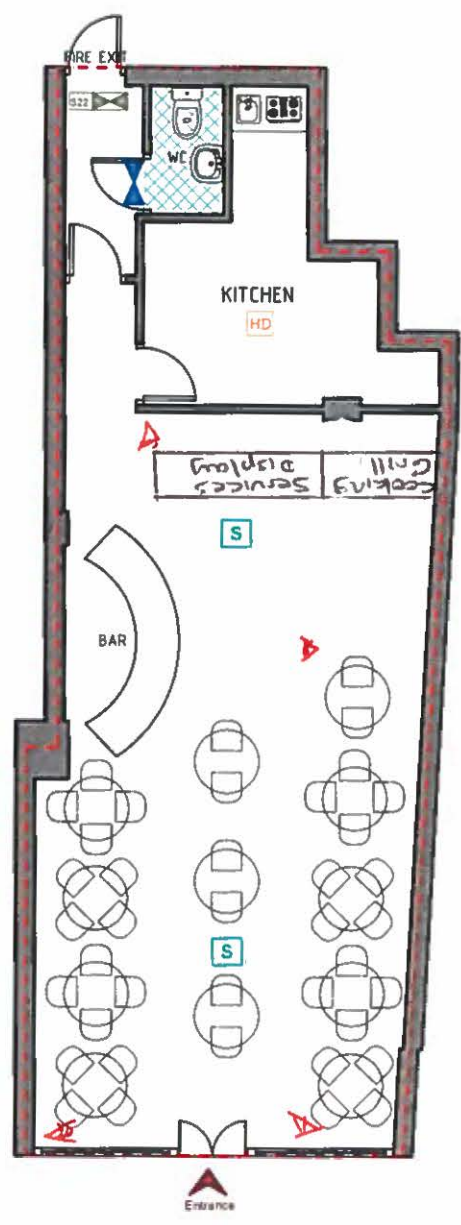

LEGEND

- CAMERA
- WC AREA
- AMBIT OF LICENSED PREMISES
- SAFETY LIGHTS
- SMOKE DETECTOR
- FIRE EXTINGUISHER
- HEAT DETECTOR
- INTERNALLY ILLUMINATED FIRE ESCAPE SIGN (BS 5266)

| | |
|-----------------------|---------------------------------|
| MEZE BAR & RESTAURANT | 160 Roman Road London E2 0RY |
| Ground Floor Plan | |
| REF. NO : | |
| SCALE : 1/100@A4 | DATE : 01/10/2013 |

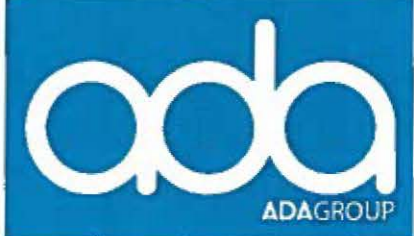
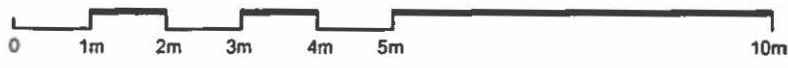

Appendix 2

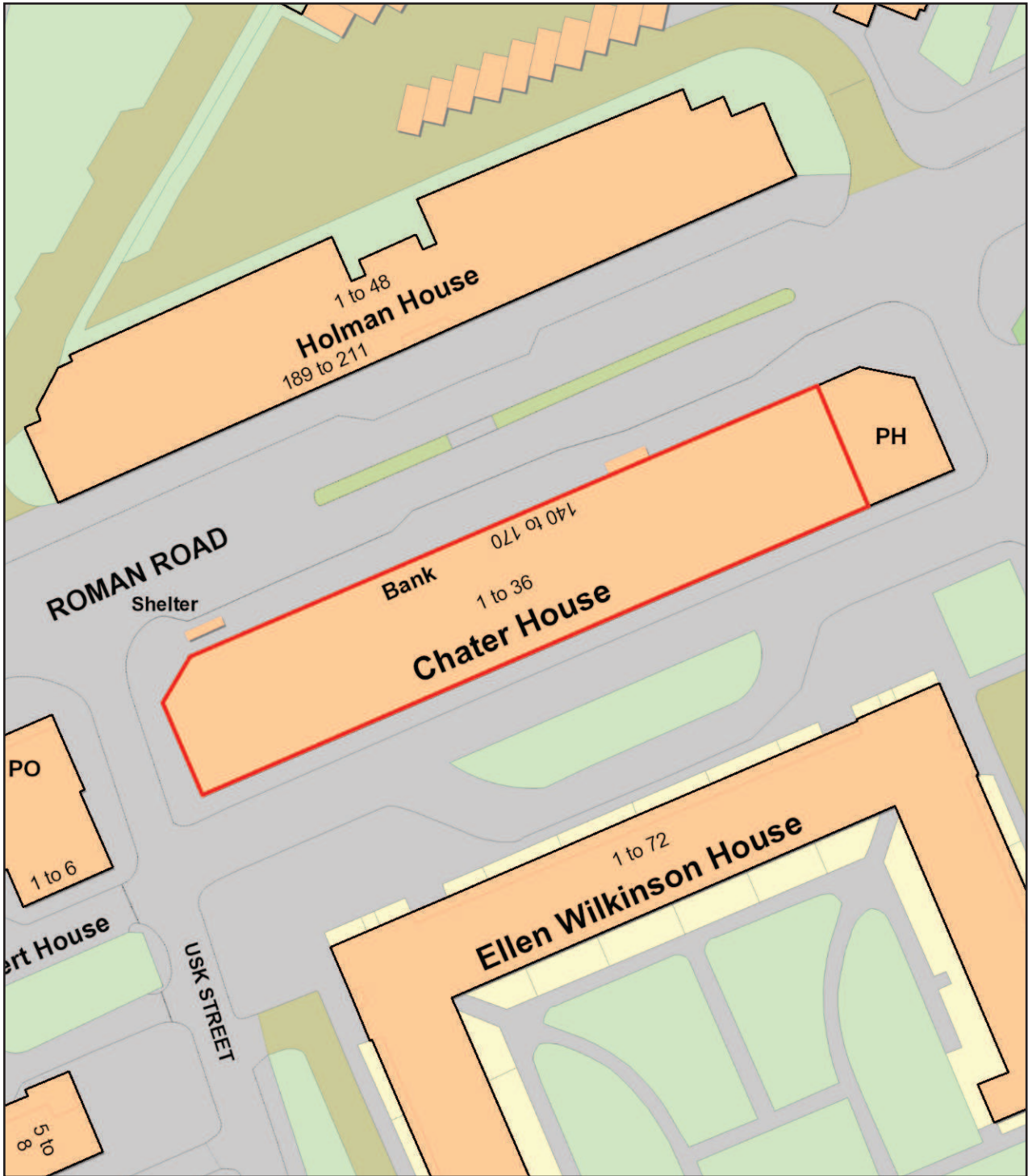

150 Roman Road

Map 1



Scale 1:668

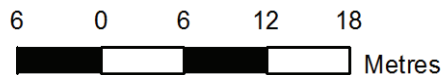

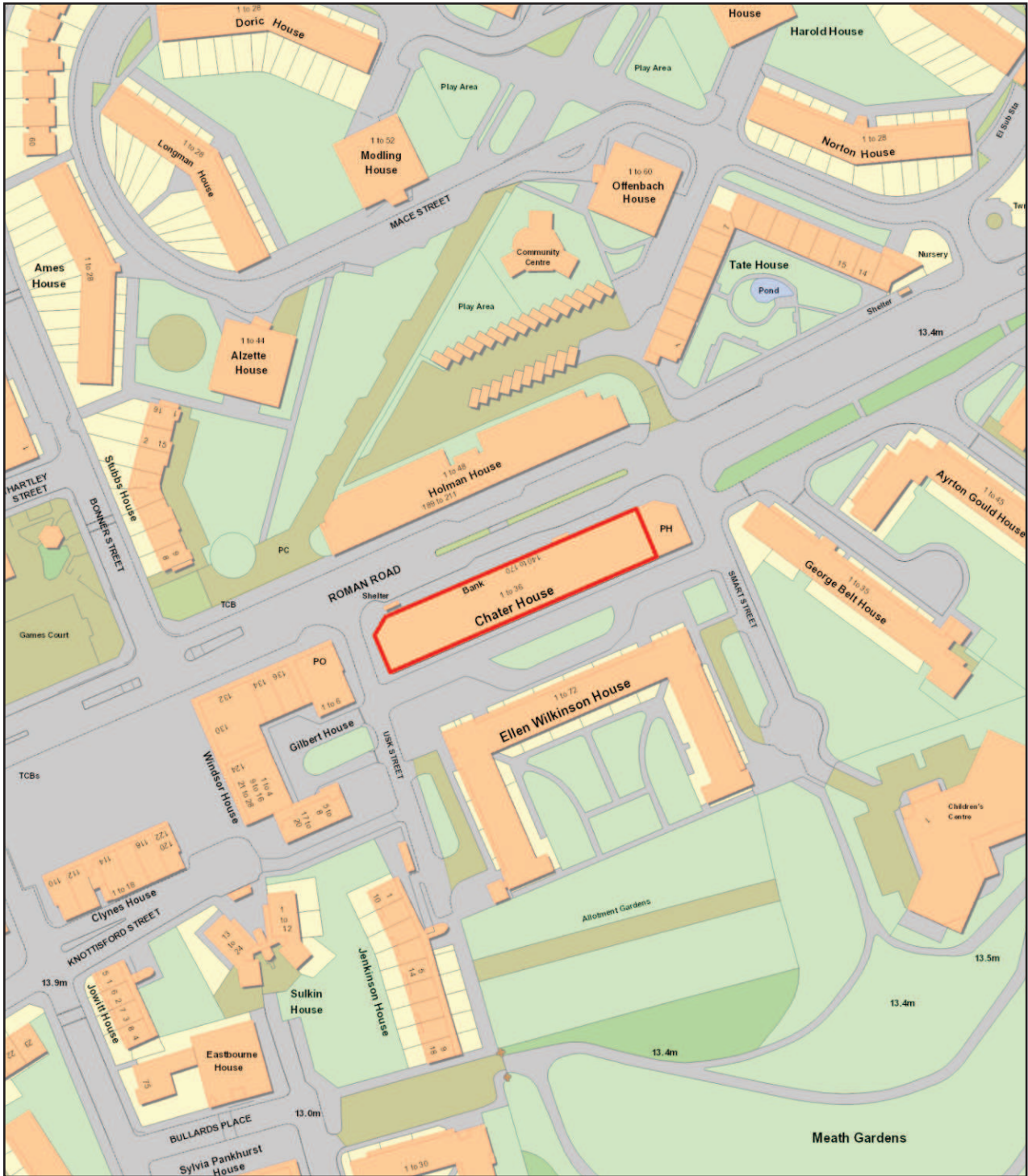

150 Roman Road

Map 2



Scale 1:1669

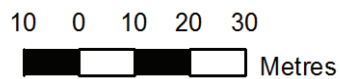

Appendix 3

Section 182 Advice by the Home Office

Updated October 2012

Relevant, vexatious and frivolous representations

- 9.4 A representation is “relevant” if it relates to the likely effect of the grant of the licence on the promotion of at least one of the licensing objectives. For example, a representation from a local businessperson about the commercial damage caused by competition from new licensed premises would not be relevant. On the other hand, a representation by a businessperson that nuisance caused by new premises would deter customers from entering the local area, and the steps proposed by the applicant to prevent that nuisance were inadequate, would be relevant. In other words, representations should relate to the impact of licensable activities carried on from premises on the objectives. For representations in relation to variations to be relevant, they should be confined to the subject matter of the variation. There is no requirement for a responsible authority or other person to produce a recorded history of problems at premises to support their representations, and in fact this would not be possible for new premises.
- 9.5 It is for the licensing authority to determine whether a representation (other than a representation from responsible authority) is frivolous or vexatious on the basis of what might ordinarily be considered to be vexatious or frivolous. A representation may be considered to be vexatious if it appears to be intended to cause aggravation or annoyance, whether to a competitor or other person, without reasonable cause or justification. Vexatious circumstances may arise because of disputes between rival businesses and local knowledge will therefore be invaluable in considering such matters. Licensing authorities can consider the main effect of the representation, and whether any inconvenience or expense caused by it could reasonably be considered to be proportionate.
- 9.6 Frivolous representations would be essentially categorised by a lack of seriousness. Frivolous representations would concern issues which, at most, are minor and in relation to which no remedial steps would be warranted or proportionate.
- 9.7 Any person who is aggrieved by a rejection of their representations on either of these grounds may lodge a complaint through the local authority’s corporate complaints procedure. A person may also challenge the authority’s decision by way of judicial review.
- 9.8 Licensing authorities should not take decisions about whether representations are frivolous, vexatious or relevant to the licensing objectives on the basis of any political judgement. This may be difficult

for councillors who receive complaints from residents within their own wards. If consideration is not to be delegated, contrary to the recommendation in this Guidance, an assessment should be prepared by officials for consideration by the sub- committee before any decision is taken that necessitates a hearing. Any councillor who considers that their own interests are such that they are unable to consider the matter independently should disqualify themselves.

- 9.9 It is recommended that, in borderline cases, the benefit of the doubt about any aspect of a representation should be given to the person making that representation. The subsequent hearing would then provide an opportunity for the person or body making the representation to amplify and clarify it.
- 9.10 Licensing authorities should consider providing advice on their websites about how any person can make representations to them.

Appendix 4

Andrew Heron

From: emilia gosling [REDACTED]
Sent: 04 November 2013 21:32
To: Andrew Heron
Subject: FW: Licensing Act 2003 and Meze Bar Restaurant, 150 Roman Road, London, E2 0RY

Dear Mr Heron

Thank you for your email below.

I do make a representation against a liquor license and the extended opening hours of the premises, for the reasons set out below:-

- There is already one late night place on the same block, the Angel & Crown Public House, had an extended license and had to put extra sound proofing in to avoid the noise late at night. There are always people hanging around the area, will there be more people hanging around at 1:00am, now the restaurant stays open late. I cannot say either way but it could be a possibility and I personally find it unnerving.
- The smell / fumes from the bbq - as mentioned previously I spoke with the builders during the fit out and they assured me that the fumes would be no longer as they were replacing the extractor mechanism, unfortunately the smoke still comes up to my window, and it is a lot worse in the summer months, as I have the windows open and the smell comes into my flat, I do believe this is not acceptable at all, and surely the extractor fan should go above all the flats up to the roof, so the smoke goes upwards, and not into my flat.

I look forward to hearing from you in this regard.

Regards

Emilia Gosling

From: Andrew.Heron@towerhamlets.gov.uk
To: [REDACTED]
Subject: RE: Licensing Act 2003 and Meze Bar Restaurant, 150 Roman Road, London, E2 0RY
Date: Tue, 29 Oct 2013 16:27:35 +0000

Dear Ms Gosling,

Please accept my apologies for the time taken to respond to your email. I have only just have your correspondence brought to my attention.

I can advise that the premises has applied for a licence for the following activities:

Late Night Refreshment (the sale of hot food and drinks): until 01:00hrs (am) – Monday to Saturday.
Alcohol: Monday to Saturday from 12:00hrs (midday) to 00:30hrs (the following day) and Sunday from 13:00hrs to 22:30hrs.

Opening Hours: Monday to Saturday from 12:00hrs (midday) to 01:00hrs (the following day) and Sunday from 12:00hrs (midday) to 23:00hrs

I will accept your email as a representation against the application as it does go beyond the hours that you have stated to be acceptable. It would be helpful for your representation if you were able to provide me with more information on your previous experience with the premises and how you believe the granting of a licence would make that worse. Please provide examples, including noxious smells, noise, instance if anti-social behaviour.

Please also make reference to one or more of the licensing objectives, namely:

- The prevention of crime and disorder
- The prevention of public nuisance
- Public Safety
- The protection of children from harm

I look forward to hearing from you. The consultation ends on 5th November. As a result of your representation, a Hearing will be held, which you will be invited to attend, once the date has been established.

Regards,

Andrew Heron
Licensing Officer

Licensing Section
London Borough of Tower Hamlets
Mulberry Place (TC)
6th Floor Mulberry Place
5 Clove Crescent
London, E14 2BG
Tel: 020 7364 2665
Fax: 020 7364 6935
www.towerhamlets.gov.uk

From: emilia gosling [REDACTED]
Sent: 15 October 2013 19:57
To: Kathy Driver
Subject: Licensing Act 2003 and Meze Bar Restaurant, 150 Roman Road, London, E2 0RY

Dear Kathy

I refer to the above application for an alcohol license and would like to understand more of what they are requesting. Whilst your letter states that we can view the application at your offices during the working week it is not possible for me to attend as I work.

The restaurant has functioned with no liquor license since opening and i do object to a license past 23:00 - as it is a restaurant, I live [REDACTED] and suffer enough from the unhealthy fumes that I was assured would be fixed during their recent renovation, unfortunately it seems that the extractor was not replaced as discussed and the fumes still come up to my flat, and now in addition they are asking for a license past 23:00 - they are residential flats above the restaurant, my one being the direct one and do not feel it appropriate for this area.

I would appreciate it if you could email the details of their request.

Many thanks.

Regards

Emilia Gosling

[Redacted signature block]

Appendix 5

Appendix 5

Anti-Social Behaviour from Patrons Leaving the Premises

General Advice

Members need to bear in mind that once patrons have left a premises they are no longer under direct control. Members will need to be satisfied that there is a link between the way the premises is operating and the behaviour that is complained of. An example of this would be that irresponsible drinking is being encouraged. Before deciding that any particular licensing conditions are proportionate, Members will also need to be satisfied that other legislation is not a more effective route. For example, if the problem is drinking in the street it may be that the Council should designate the area as a place where alcohol cannot be consumed in public.

Members may also wish to consider whether the hours of opening relate to any problems of anti-social behaviour.

If Members believe that there is a substantial problem of anti-social behaviour and it cannot be proportionately addressed by licensing conditions they should refuse the application.

Licensing Policy

The policy recognises that other legislation or measures may be more appropriate but also states that licensing laws are “a key aspect of such control and will always be part of an overall approach to the management of the evening and night time economy.” **(See Section 4.10 and 4.11 of the Licensing Policy).**

The Licensing Authority expects the applicant to have addressed all crime and disorder issues relating to the premises in their operating schedule and to have sought appropriate advice. **(See Sections 5.2 of the Licensing Policy)**

The Licensing Authority will consider attaching conditions to deter crime and disorder and these may include Conditions drawn from the Model Poll of Conditions relating to Crime and Disorder. **(See Appendix 2 Annex D of the Licensing Policy).** In particular Members may wish to consider (this list is not exhaustive):

- Bottle Bans
- Plastic containers
- CCTV (outside the premises)
- Restrictions on open containers for “off sales”
- Proof of Age scheme
- Crime prevention notices
- Drinks promotions-aimed at stopping irresponsible promotions
- Signage

Cumulative Impact

There is a process by which the Licensing Authority can determine that an area is saturated following representations. However, the process for this involves wide consultation and cannot come from representations about a particular application. (**See Section 6 of the Licensing Policy**).

Police Powers

The Licensing Act 2003, Part 8 gives a senior police officer the power to close a premises for up to 24 hours where the officer believes there is, or is likely to be disorder on or in the vicinity and closure is necessary in the interests of public.

Guidance Issued under Section 182 of the Licensing Act 2003.

The pool of conditions, adopted by the council is recommended (13.20).

The key role of the police is acknowledged (2.2).

Conditions attached to licences cannot seek to manage the behaviour of customers once they are beyond the direct management of the licence holder, but can relate to the immediate vicinity of the premises as they seek entry or leave (2.4).

Conditions are best targeted on deterrence and preventing crime and disorder (S.2.6) communication, police liaison, no glasses are all relevant (s.2.7-2.11).

There is also guidance issued around the heading of "public nuisance as follows

The pool of conditions, adopted by the council is recommended (Annexe D).

Licence conditions should not duplicate other legislation (1.16).

Necessary and appropriate conditions should normally focus on the most sensitive periods and may address disturbance as customers enter or leave the premises (2.36) but it is essential that conditions are focused on measures "within the direct control of the licence holder" (2.38).

Other Legislation

Crime and Disorder Act 1998

The Council has a duty under Section 17 of the Crime and Disorder Act 1998 to do all it reasonably can to prevent crime and disorder.

The Act also introduced a wide range of measures designed to address anti-social behaviour committed by adults and young people. These include:

- Anti-Social Behaviour Orders
- Child Curfew Schemes
- Truancy
- Parenting Orders
- Reparation Orders
- Tackling Racism

Appendix 6

Appendix 6

Noise while the premise is in use

General Advice

If they conclude this is a problem Members should consider whether it is possible to carry out suitable and proportionate noise control measures so that noise leakage is prevented. In addition Members may consider that only certain activities are suitable.

The hours of operation also need to be considered (see below).

If Members believe that there is a substantial problem of noise while the premises are in use and it cannot be proportionately address by licensing conditions they should refuse the application.

Licensing Policy

The policy recognises that noise nuisance can be an issue, especially if a premises is open late at night. **(See Sections 8.1 of the Licensing Policy)**.

The policy also recognises that staggered closing can help prevent problems at closure time **(See Section 12.1)**.

However, while all applications will be considered on their merits, consideration will be given to imposing stricter conditions in respect of noise control where premises are situated close to local residents. **(See Section 12.4)**.

The Licensing Authority expects the applicant to have addressed all nuisance issues relating to the premises in their operating schedule and to have sought appropriate advice from the Council's Environmental Health Officers. **(See Sections 8.2 of the Licensing Policy)**.

The Licensing Authority will consider attaching conditions to prevent nuisance and these may include Conditions drawn from the Model Poll of Conditions relating to Crime and Disorder. **(See Appendix 2 Annex D of the Licensing Policy)**. In particular Members may wish to consider (this list is not exhaustive):

- hours of opening (this needs to be balanced against potential disorder caused by artificially early closing times)
- Whether certain parts should close earlier than the rest (for example a "beer garden", or restricted in their use)
- Whether or not certain activities should have to close at an early hour, for example live music
- Conditions controlling noise or vibration (for example, noise limiters, keeping doors and windows closed).

- Prominent clear and legible notices at all exits requesting the public to respect the needs of local residents and leave the premises and area quietly
- Conditions controlling the use of explosives, pyrotechnics and fireworks
- Conditions controlling the placing of refuse
- Conditions controlling noxious smells
- Conditions controlling lighting (this needs to be balanced against potential crime prevention benefits)

Police Powers

Part 8 of the Licensing Act 2003 enables a senior police officer to close down a premises for up to 24 hrs. a premises causing a nuisance resulting from noise emanating from the premises.

Guidance Issued under Section 182 of the Licensing Act 2003

The prevention of public nuisance could include low-level nuisance, perhaps affecting a few people living locally as well as major disturbance affecting the whole community (2.33).

Licence conditions should not duplicate other legislation (1.19)

Any conditions should be tailored to the type, nature and characteristics of the specific premises. Licensing authorities should be aware of the need to avoid inappropriate or disproportionate measures that could deter events that are valuable to the community, such as live music. Noise limiters, for example, are very expensive to purchase and install and are likely to be a considerable burden for smaller venues. (2.20)

Necessary and appropriate conditions should normally focus on the most sensitive periods (2.22) and may address disturbance as customers enter or leave the premises but it is essential that conditions are focused on measures within the direct control of the licence holder.

Other Legislation

The Environmental Protection Act 1990, Part 111 gives Environmental Health Officers the power to deal with statutory nuisances.

The Anti-social Behaviour Act 2003, Sections 40 and 41 give Environmental Health Officers the power of closure up to 24 hours in certain circumstances

Appendix 7

Access and Egress problems

Such as:

Disturbance from patrons arriving/leaving the premises on foot

Disturbance from patrons arriving/leaving the premises by car

Lack of adequate car parking facilities

Close proximity to residential properties

Comment

The above have been grouped together as egress problems. Of course the particular facts will be different for each alleged problem.

Egress only is referred to-if necessary access can be added or substituted in.

General Advice

In considering concerns relating to disturbance from egress, Members need to be satisfied that the premises under consideration has been identified as the source of the actual or potential disturbance. If they are satisfied that this is a problem, then proportionate conditions should be considered.

The hours of operation also need to be considered.

If Members believe that there is a substantial problem concerning egress and it cannot be proportionately addressed by licensing conditions, they should refuse the application.

Licensing Policy

The policy recognises that noise nuisance can be an issue, especially if a premises is open late at night. (**See Section 8.1 of the Licensing Policy**).

The Licensing Authority expects the applicant to have addressed all nuisance issues relating to the premises in their operating schedule and to have sought appropriate advice from the Council's Environmental Health Officers. (**See Section 8.2 of the Licensing Policy**).

The policy also recognises that staggered closing can help prevent problems at closure time (**See Section 12.10**).

However, while all applications will be considered on their merits, consideration will be given to imposing stricter conditions in respect of noise control where premises are situated close to local residents. (**See Section 12.10**)

The Council has adopted a set of framework hours (**See 12.8 of the licensing policy**). This relates to potential disturbance caused by late night trading.

The Licensing Authority will consider attaching conditions to prevent nuisance and these may include Conditions drawn from the Model Pool of Conditions relating to the prevention of Public Nuisance. (**See Appendix 2 Annex G of the Licensing Policy**). In particular Members may wish to consider (this list is not exhaustive):

- hours of opening (this needs to be balanced against potential disorder caused by artificially early closing times)
- Whether certain parts should close earlier than the rest (for example a “beer garden”, or restricted in their use)
- Whether or not certain activities should have to close at an early hour, for example live music
- Conditions controlling noise or vibration (for example, noise limiters, keeping doors and windows closed).
- Prominent clear and legible notices at all exits requesting the public to respect the needs of local residents and leave the premises and area quietly

Guidance Issued under Section 182 of the Licensing Act 2003

The prevention of public nuisance could include low-level nuisance, perhaps affecting a few people living locally as well as major disturbance affecting the whole community. (2.33).

Licence conditions should not duplicate other legislation (1.19).

Any conditions should be tailored to the type, nature and characteristics of the specific premises. Licensing authorities should be aware of the need to avoid inappropriate or disproportionate measures that could deter events that are valuable to the community, such as live music. Noise limiters, for example, are very expensive to purchase and install and are likely to be a considerable burden for smaller venues. (2.20)

Measures can include ensuring the safe departure of customers, these can include:

- Providing information on the premises of local taxi companies who can provide safe transportation home; and
- Ensuring adequate lighting outside the premises, particularly on paths leading to and from the premises and in car parks

Necessary and appropriate conditions should normally focus on the most sensitive periods (2.22) and may address disturbance as customers enter or leave the premises but it is essential that conditions are focused on measures within the direct control of the licence holder.

Appendix 8

Noxious smells or light pollution

General Advice

Members need to be satisfied that any problems cannot be adequately addressed by existing legislation. Conditions must relate proportionately to the licensable activity. Thus for example, a café that is emitting noxious smells does so whether or not it is permitted to open past 23 00 hrs.

Any nuisance from bright lights needs to be balanced against potential crime and disorder benefits from bright lights.

Other Legislation

The Environmental Protection Act 1990

Part 111 of the Act gives Environmental Health Officers the power to deal with statutory nuisances including smells

Planning legislation may restrict external lighting.